

 **Electrolux**

伊莱克斯全自动滚筒洗衣机  
使用说明书

WASHING MACHINE INSTRUCTION MANUAL



MODEL

EW 1290W



## 亲爱的用户：

在使用本产品之前，请仔细阅读本说明书，尤其是注意事项说明。并请妥善保管，以备将来使用参考。

## 产品运输检查：

拆开产品包装后立即检查洗衣机在运输过程中有无损伤，如有问题请与售后服务中心联系。

本说明书中出现的下列图标，请仔细阅读：

-  此警告标志及其关键词（警告！注意！）  
强调：这些信息对您的安全和洗衣机的正确使用非常重要。
-  此标志提供洗衣机使用中的附加说明和实用技巧。
-  此标志提供有关经济和环保方面的提示和信息。

为保护环境，我们使用可回收纸张

# 目录

注意事项	3-4	洗衣指南	14
废弃处理	4	衣物分类	14
环保提示	4	温度设定	14
技术规格	5	污渍预处理	14
安装	6	衣物检查	14
拆除包装	6	最大洗衣量	14
洗衣机放置	6	衣物重量	14
进水	6	洗涤剂 and 添加剂	15
排水	7	洗涤剂用量	15
电气连接	7	干衣指南	16
您的新洗衣干衣机	8	干衣量确定	16
部件说明	8	不适合烘干的衣物	16
门锁指示灯	8	衣物标签上的干衣符号	16
洗涤剂抽屉盒	8	干衣时间	16
控制面板描述	9	残留纤维	16
电源开/关按钮	9	附加烘干	16
电源指示灯	9	操作步骤	17-20
织物选择按钮	9	程序表	21
温度选择按钮	9	定时烘干	22
脱水转速选择按钮	9	国际洗涤标志	23
选项按钮	10	维护保养	24
自动烘干按钮	10	门封	24
烘干时间按钮	10	机身	24
显示屏	10	洗涤剂抽屉盒	24
启动/暂停按钮	11	排水泵	24
单选/重置按钮	11	进水阀过滤器	25
预约按钮	11	紧急事故处理	25
洗涤过程指示灯	13	预防冻结	25
		故障诊断	26-27

## 注意事项

下列警示提供了所有有关安全的事项。

在安装及使用本产品之前请仔细阅读：

### 安装

- 使用产品前请去除所有包装物，如果在使用前没有拆除或没有完全拆除运输过程中的保护装置，会严重损害洗衣机或邻近家具，请注意说明书中相关章节。
- 所有电气及管道连接必须由专业人员安装。
- 安装结束后确保洗衣机没有压着电源线。
- 若将洗衣机放置在地毯上，须确保洗衣机底部与地板之间的空气流通。

### 使用

- 本产品专为家庭使用而设计，不要用于商业、工业和其它用途。
- 只有适宜机洗和机器烘干的衣物面料才可进行洗涤和烘干，请参考衣物标签说明。
- 请勿超过额定洗涤容量，按照说明书要求使用。
- 洗涤衣物前，须取掉衣服上的别针、徽章或口袋中的硬币、螺丝等异物，否则会损伤洗衣机和衣物。
- 不要将洗衣机洗涤沾有汽油、香蕉水等挥发性易燃液体，若洗衣前使用上述液体去除污渍，请等完全挥发后再把衣物放入洗衣机。
- 请把小物件（如手绢、袜子、丝带等）放在洗衣袋或枕头套中进行洗涤，防止落入内外筒之间。
- 若您因使用洗衣液须将洗衣液直接放进洗涤抽屉内，谨记在干衣前应清洗洗涤抽屉。

- 使用推荐的适量柔软剂，过多的柔软剂会损伤衣物。
- 洗衣机不使用时，请将玻璃门微微打开，可保护洗衣机门封，并可防止洗涤筒内产生异味。
- 打开机门之前，请确认筒内的水已经排干。如果没有，请按说明书说明排水。
- 洗衣机使用后，请拔下电源插头并关闭水龙头。

### 安全事项

- 洗衣机必须由专业人员维修，非专业人员维修可能会产生危险。请咨询当地维修中心。
- 拔掉电源插头时，必须手握前端插头部分，切勿拉扯电线。
- 高温洗涤或烘干时，请勿碰触机门玻璃以免烫伤。
- 在清洗和修理洗衣机前，请拔下电源插头。
- 不要让洗衣机曝晒和雨淋。
- 不要把水直接浇到洗衣机上。

## 儿童保护

- 本洗衣机专为成人使用设计，不允许儿童接触、玩耍。
- 用于包装的零部件（塑料薄膜、泡沫垫等）会对儿童造成伤害、窒息，请妥善保存在儿童不能取到的地方。
- 所有洗涤剂请放置在安全的地方，以防儿童触摸。
- 确保儿童及宠物不会爬进洗衣筒中。为避免此类情况的发生，本机设有特殊装置。要使用此装置，请使用一枚硬币，顺时针旋转机门内的旋钮（不要按下），直至凹槽呈水平状态；若要取消此功能，使机门恢复可关闭状态，可逆时针旋转旋钮，直至凹槽呈垂直状态。

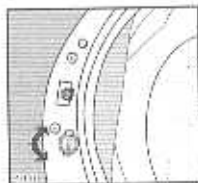

- 废弃洗衣机时，应剪断电源线并销毁带有剩余电线的电源插头，使门锁失效，以防止儿童游戏时受困。

## 环保提示

### 包装材料

如材料上有“△”标志表明可以再循环利用。

- >PE<= 聚乙烯
- >PS<= 聚苯乙烯
- >PP<= 聚丙烯

经过适当的收集后可以回收再利用。

## 洗衣机

将您的旧洗衣机放置在指定废物处理地点，请保持环境整洁。

## 环保提示

为了节水节能和保护环境，我们建议遵循下列提示：

- 为了节省洗涤剂用量，缩短洗衣时间及降低耗水量，建议脏污程度一般的衣物不需要进行预洗。
- 若用尽最大的洗衣和干衣量，洗衣机运行更经济，但不要超出最大洗涤容量和烘干容量。
- 烘干前充分脱水可减少能耗。
- 对衣物进行适当预处理，可以去除污渍和轻微的脏污，以便以较低温度洗涤衣物。
- 根据水质硬度、衣物脏污的程度以及洗衣量选择合适洗涤剂用量。

## 技术规格

尺寸	高	85 cm	
	宽	60 cm	
	深	61 cm	
额定最大容量	棉麻织物	洗涤量 6.5 kg	烘干量 3.5 kg
	化纤织物	3 kg	2 kg
	丝绸织物	3 kg	
	羊毛织物	2 kg	
脱水转速		最大1200 转/分钟	
电源电压/频率		AC 220V/50 Hz	
总输入功率		2000 W	
额定电流		10A	
水压	最小	50 kPa	
	最大	800 kPa	

# 安装

## 拆除包装

**⚠** 在使用洗衣机前，必须拆除所有运输螺栓和包装。

建议保存洗衣机所有的运输装置，以便于再次搬运时使用。

1. 用扳手拧松并取出洗衣机后背的两个运输螺栓，取出塑料护套。

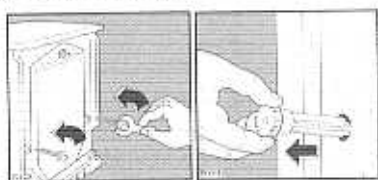

2. 将洗衣机背朝地平放，在洗衣机和地板之间放置角垫以避免压扁排水管。
3. 移去洗衣机底部的包装泡沫块，拧松并取出四个机脚，松开两个塑料袋。
4. 先往右然后向下，小心拉出左边的塑料袋。

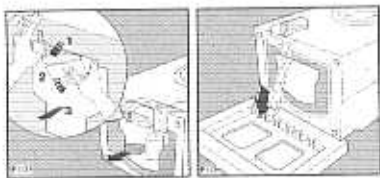

5. 先往左然后向上，小心拉出右边的塑料袋。

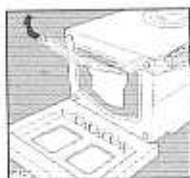

6. 把洗衣机放正，然后从洗衣机后背取出剩余的运输螺栓，取出塑料护套。

7. 从放在洗衣筒中的说明书附件塑料袋中取出三只孔塞塞住螺栓孔。

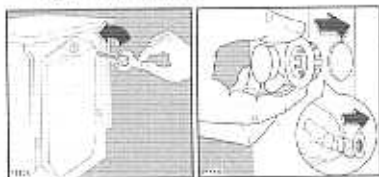

## 洗衣机放置

- 把洗衣机放置在平整、坚实的地面上。
- 确保洗衣机周围空气流通，没有被地毯、垫子等阻塞。
- 检查洗衣机没有紧靠墙壁或其它物体。
- 通过左右旋转洗衣机可调底脚，使洗衣机水平放置，否则，洗衣机在洗涤或脱水中会产生较大的噪音或震动。不要在洗衣机底部放置垫片、木块或其它类似物体来调节水平。

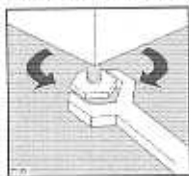

## 进水

- 从内筒中的附件袋中取出进水管接头（A和B）。
- 将连接应A套在水龙头上，拧紧四颗固定螺母，再把进水管接头B旋紧，注意旋紧后不得有滴水现象。
- 进水管滑动接口与进水管接头连接时，先压下滑动头C，将进水管插入进水管接头B，松开后再将进水管拉一下，确认已插到位。
- 进水管螺纹接口与进水阀口连接时，要防止拧偏螺纹造成连接处滑牙、漏水。
- 应避免进水管过度弯曲造成损伤。

- 与洗衣机相连的进水管的另一端可以朝任意方向旋转。松开连接装置，旋转软管，重新上紧，确认没漏水。
- 进水管不应太长，如太长且不想移动水龙头，您可以另购一根加长进水管。

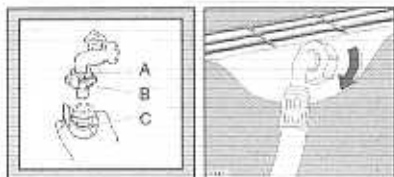

- 直接将排水管末端与排水管道相连，排水管道高度在60~90cm之间。
- 排水管口必须保持畅通，排水管道的内径必须大于排水管的外径。
- 排水管不应扭结。

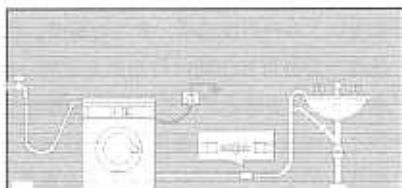

## 排水

排水管末端可用三种方式放置：

- 使用随机提供的塑料弯头装在排水管末端上，将其挂在水槽壁上。在此情况下，应确保洗衣机在排水时，排水管不能掉下。可将排水管系在水龙头上或固定在墙上。

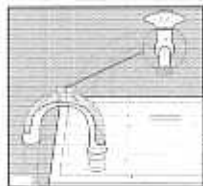

- 排水管接于水槽的排水分支。排水分支必须位于下水道上方并使弯曲部分最少高于洗衣机放置平面60cm以上。

## 电气连接

- 此洗衣机使用单相220V/50Hz电源。
- 确保家用供电线路能承受所要求的最大负载，同时须考虑其它电器同时工作时的负载。
- 洗衣机应使用单独的电源插座，禁止使用引出线及多路拖线板连接。
- 洗衣机必须连接至可靠接地的三孔电源插座。

**⚠** 任何不遵从上述安全规定而造成的后果，制造商概不负责。  
电源线的更换必须由售后服务中心完成。

## 重要！

确保安装好的洗衣机便于连接电源插座。

# 您的新洗衣干衣机

这台拥有伊莱克斯专利新型直喷技术的洗衣机能够满足现代洗衣需求，省水省电，并节省洗涤剂用量。

洗涤少量衣物时更节省，因为水电消耗量与所洗衣物的数量和类型成比例。



- 本机提供了各种程序选项，并可对温度、脱水转速进行选择，真正实现了按客户需要洗涤衣物。
- “预约”功能可让您随时约定洗衣时间。例如：利用夜间的经济电价洗衣，可以省开支。
- “免排水”功能适用所有织物：衣物浸在最后一次漂洗的水中以防止皱褶。
- “程序进程指示灯”，显示所选程序进程和当前运行状态。
- “特殊的羊毛程序”，带有轻柔洗衣系统，精心呵护您的羊毛织物。
- “烘干程序”，无论何种天气，都能给您的洗涤带来柔和、轻松的感觉。
- “3格洗涤剂抽屉盒”方便放置洗涤剂和织物柔软剂。
- “平衡控制装置”确保洗衣机在脱水过程中保持平稳。

## 部件说明

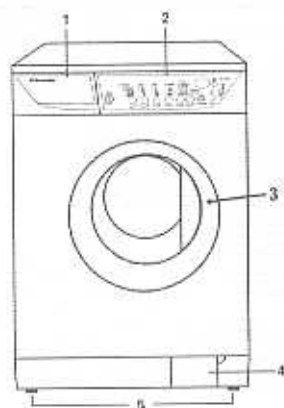
1. 洗涤剂抽屉盒
2. 控制面板
3. 门锁指示灯
4. 排水过滤器
5. 水平调整脚



### 洗涤剂抽屉盒

-  预洗洗涤剂投放格
-  主洗洗涤剂投放格
-  柔软剂、上浆剂投放格

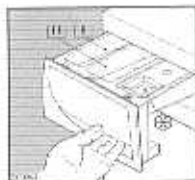

# 控制面板描述

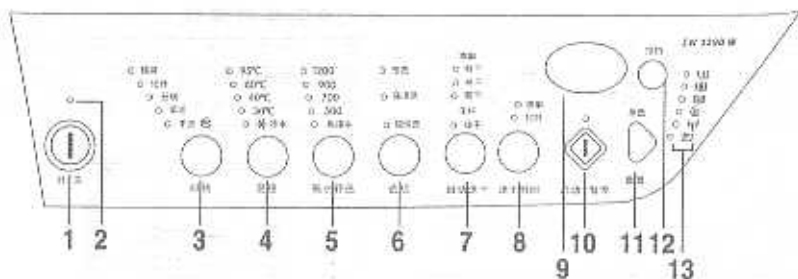

## 1. 电源开/关按钮

按下电源“开/关”按钮，接通洗衣机电源。显示窗(9)将显示三条闪烁横线或闪烁的数字“0”。详细说明请参见P10-11(参见显示窗部分)。再次按下该键可关闭电源。

## 2. 电源指示灯

按下电源“开/关”按钮，电源指示灯点亮或熄灭。

## 3. 织物选择按钮

依照所需洗涤的织物类型重复按动此键选择洗涤程序，直到相应指示灯点亮。洗衣机会根据所选的洗涤程序自动设定洗涤温度和最高脱水转速。您可以通过按钮4、5改变温度和转速。

### 手洗

当你选择了这个程序，机器将进行特别轻柔的洗涤，适合洗涤衣物标签上标明必须手洗的衣物。

## 4. 温度选择按钮

如果不想使用机器自动设定的温度，可通过重复按动此键增加或减少洗涤温度，相应指示灯点亮。纯棉的最高洗涤温度为95℃，化纤的最高洗涤温度为60℃，丝绸、羊毛和手洗织物的最高洗涤温度为40℃。

选择“\*冷水”位置时，洗衣机将用冷水洗涤。用于特别精致的织物，如窗帘。

### 重要！

同时按下温度和脱水转速按钮，在程序运行结束后，程序设定和错误选择时都不发出提示音。

## 5. 脱水转速选择按钮

如果不想使用机器自动设定的脱水转速，可通过重复按动此键改变脱水转速，相应指示灯点亮。

不同织物的最大脱水转速如下：

棉麻：1200 转/分钟

化纤、羊毛、干洗：900转/分钟

丝绸：700转/分钟

免排水：

选择此功能时，最后一次漂洗的水不排出，以防织物起皱。洗涤结束时，“启动/暂停”指示灯闪烁，门锁指示灯亮，显示窗显示状态的数字0，表明筒内的水必须排出。

为了结束此过程，可选择下列一项：

### • 排水和脱水

按下“启动/暂停”按钮。机器先排水，然后按照所选程序的最高脱水转速进行脱水。

选择“脱水转速”，通过按钮5，选择脱水转速，然后按下“启动/暂停”按钮。

### • 单排水

按“单选/重置”按钮一次，使排水指示灯点亮，然后按下“启动/暂停”按钮。

### 重要！

如果你意外的多次按动“单选/重置”按钮，显示窗会显示三根闪烁的横线。要完成排水，请按动织物按钮，选择任何一个程序，然后按动“单选/重置”按钮三次，选择单排水（此时只有排水指示灯亮），按下“启动/暂停”按钮。

## 6. 选项按钮

按动此键可选择下列功能：

- **预洗：**  
如果想在主洗之前进行预洗，可选择此项功能（羊毛和手洗程序没有此项功能）  
预洗结束后，棉麻和化纤程序将进行650转/分钟的短时脱水；但丝绸程序则只进行排水。
- **强漂洗：**  
除羊毛和手洗，其它程序都可选择此功能，机器运行4次漂洗而不是3次。  
此功能适合对洗涤剂敏感的人以及水质很软的地区。
- **超快洗：**  
此功能适合于轻微脏污的衣物（羊毛和手洗程序没有此功能）。  
洗涤时间将按照所选程序和加热温度相应减少。  
预洗，强漂洗和超快洗功能不能同时选用。

## 7. 自动烘干按钮

此按钮可选择棉麻和化纤织物所需的烘干程度：

特干（棉麻）

晾干（棉麻和化纤）

烫干（棉麻）

相应指示灯点亮，机器自动调整烘干时间，使衣物达到所需的烘干程度。

## 8. 烘干时间按钮

按下此按钮可选择棉麻或化纤织物的定时烘干程序，相应指示灯点亮，若要选择棉麻，需按下此键2秒左右。

要选择烘干时间，长按此按钮直至显示屏上出现所需的烘干时间。

—对棉麻织物，所选烘干时间从10分钟至130分钟

—对化纤织物，所选烘干时间从10分钟至100分钟

每按一次此键，烘干时间以5分钟递增。

## 9. 显示屏

显示屏显示下述信息：

### • 三条闪烁的横线：

通过“单选/重置”按钮取消程序时或先前的程序已取消后再次按下电源“开/关”按钮重新开机时，该区域显示三条闪烁的横线，表示机器处于初始状态。

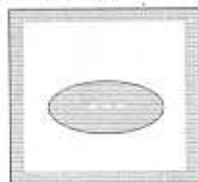

### • 洗涤时间：

当您选择某一程序时，洗涤时间以小时、分钟的形式显示，当您按下“启动/暂停”按钮运行程序时，洗涤时间以分钟为单位递减。



### • 烘干时间：

所选的烘干时间以小时、分钟的形式显示，当您启动烘干程序后，烘干剩余时间以分钟为单位递减。

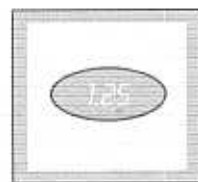

- 免排水状态显示：

当带有免排水功能的程序运行结束后，该区域显示静态的数字“0”。（洗涤结束后不排水）

- 程序结束显示：

程序运行结束时，该区域显示闪烁的数字“0”。同时门锁指示灯熄灭。

若没有通过“单选/重置”按钮取消先前运行的程序，则下次开机时仍将显示该数字“0”。

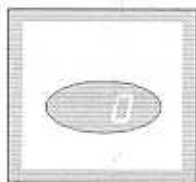

**重要！**

当您接通电源，第一次使用洗衣机时，该区域可能会显示闪烁的数字“0”，同时洗衣机发出报警提示音，这是因为洗衣机在生产商处进行测试时运行了某一程序，当该过程结束时，此程序未被清除。

- 预约时间显示：

按下预约按钮，选定预约时间：该时间以小时形式显示，显示约3秒钟，然后恢复为所选程序的运行时间。当按下“启动/暂停”按钮，预约倒计时开始，预约剩余时间以小时为单位递减。所选预约时间最多为24小时，以一小时为间隔。



- 错误操作提示：

您如果选择了与当前程序不兼容的功能，显示屏将显示错误信息“Err”，同时洗衣机将发出报警声音，以示操作不当。



- 故障代码显示：

提示洗衣机运行过程中的故障代码：（参见页码相关章节）



## 10. 启动/暂停按钮

该按钮有三个功能：

- 启动：

选择所需程序及功能后，按下此按钮启动洗衣机，此按钮之上的启动/暂停指示灯停止闪烁变为常亮。若您通过按钮12选择了预约功能，预约倒计时开始，显示屏显示预约剩余时间。

- 暂停：

当洗衣机在运行时，按下此按钮，程序暂停，启动/暂停指示灯开始闪烁；当再次按下此按钮，程序继续运行。



当程序处于暂停状态，并且符合下述三个条件，门锁指示灯熄灭，此时可打开机门：

- 洗衣机不处于加热或烘干状态
- 筒中的水位不高
- 洗衣筒不在旋转

### 重要！

若需改变正在运行的程序，请先让洗衣机处于暂停状态

- 当带有免排水功能的程序运行结束后，请排水和脱水。

## 11. 单选/重置按钮

程序结束时，您必须按动一次或重复按动此按钮，以删除先前运行的程序（显示窗将显示三条闪烁的横线）；否则，下次开机时，显示窗将显示闪烁的数字“0”，同时洗衣机发出前次程序运行结束时的报警声。

您还可以按动“单选/重置”按钮删除当前运行程序的一个或多个洗涤过程。操作如下：

- 按动“启动/暂停”按钮，使洗衣机处于暂停状态（相应指示灯闪烁）。
- 按一次或多次“单选/重置”按钮，直到想删除的过程被取消（该过程对应的指示灯熄灭）。

例如：



在此种情况下，仅有排水和脱水过程将被执行（脱水转速按所选织物类型而定）。此按钮还允许您选择特殊功能，如：漂洗、脱水及排水。

- 如果洗衣机刚运行完某一程序后仍处于开机状态，可进行以下操作：

- 按下“单选/重置”按钮一次或多次以取消先前运行的程序（显示窗显示三条闪烁的横线）；

- 通过“织物”按钮选择织物类型；

- 通过“单选/重置”按钮选择特殊功能；

### • 漂洗

按一次“单选/重置”按钮，主洗指示灯熄灭。

### • 脱水

按二次“单选/重置”按钮，主洗、漂洗指示灯熄灭。

### • 排水

按三次“单选/重置”按钮，主洗、漂洗、脱水指示灯熄灭，仅排水指示灯亮。

例如：



在此种情况下，洗衣机会运行漂洗及脱水过程。

- 若洗衣机处于关机状态：

- 按下电源“开/关”按钮开机；
- 通过“织物”按钮选择织物类型；
- 按上述步骤选择特殊功能。

## 12. 预约按钮

选定此功能，洗衣机可在最长24小时内进行预约洗涤；您选定的预约时间显示约3秒，此后，重新显示洗涤运行时间。

您必须在选定程序后及按下“启动/暂停”按钮前选择此功能。

显示窗显示的预约时间以小时为单位递减。

在按下“启动/暂停”按钮前，您可以随时改变预约时间。

如果您已按下“启动/暂停”按钮，但想改变或取消预约时间，您可进行下述操作：

- 按下“启动/暂停”按钮，使洗衣机处于暂停状态；
- 按下“预约”按钮直至显示屏显示所需的预约时间，或
- 按一次“预约”按钮，取消预约时间，同时显示屏显示“Off”。
- 再次按下“启动/暂停”按钮。

**重要！**

在预约过程中，洗衣机门将被锁上（门锁指示灯亮）。

如果您需要打开机门，先必须按下“启动/暂停”按钮，使洗衣机处于暂停状态；关上机门后，再次按下“启动/暂停”按钮，可重新启动洗衣机。

### 13. 洗涤过程指示灯

当您选定某一程序时，该程序不同过程的相应的指示灯亮。



当您启动程序后，只有正在运行中的过程指示灯保持点亮。

## **i** 洗衣指南

### 衣物分类

按照衣物的洗涤标志及厂商对衣物的洗涤说明，将衣物进行如下分类：

白色衣物、有色衣物、化纤织物、丝绸织物、羊毛织物。

### 温度设定

**95℃** 适合脏污程度严重的纯棉和亚麻织物。（例如：抹布、毛巾、桌布、床单等）

**60℃** 适合脏污程度一般，不易褪色的纯棉、亚麻、化纤衣物（如：衬衣、睡衣、睡裤）以及脏污程度轻微的白色纯棉织物（如：内衣内裤）。

**\*冷水 30℃-40℃** 适合丝织类织物（如：丝质窗帘），混纺衣物包括化纤和可机洗的羊毛织物。

### 污渍预处理

普通洗涤难以去除顽固的污渍，建议预先对顽固污渍进行处理，可用专用洗涤剂擦洗沾有特殊污渍的地方。

若用易挥发的有机溶剂（如：酒精、汽油等）处理衣物污渍时，请等此类物质完全挥发后再将衣物放入洗衣筒。

### 衣物检查

- 不要将白色和易褪色衣物放在一起洗，以免使白色衣物染色。
- 新的有色衣物在第一次洗涤时可能褪色，因此第一次洗涤时应单独分离洗涤。
- 清空衣物口袋，确保待洗的衣物中无遗漏的金属制品（如：发卡、别针、大头针、硬币等）。
- 扣好枕套：拉上衣物拉链、钩子；缝牢或取下衣物上的松动纽扣，系好衣物的带子等。

- 将小物件（如：丝袜、手帕等）放入洗衣袋中，以免陷入内外筒之间。
- 洗涤窗帘时要特别小心，应摘下挂钩或将所有挂钩包进布袋或洗衣网袋中。

### 最大洗衣量

各种织物推荐的最大洗衣量详见程序表。通常情况下，衣物按如下程度盛放：

- 纯棉、亚麻织物放满内筒但不能太挤；
- 化纤衣物盛放不超过洗衣筒容积一半；
- 丝绸、羊毛及手洗织物不超过洗衣筒容积的三分之一。

以最大的洗涤量洗涤可最有效地利用水和能源。

对于很脏的衣物，请减少洗涤量。

### 衣物重量

参考如下：

浴衣	1200 g
餐巾	100 g
被单	700 g
床单	500 g
枕套	200 g
桌布	250 g
毛巾	200 g
抹布	100 g
睡裙	200 g
女士内衣	100 g
工作服	600 g
男士衬衫	200 g
男士睡衣	500 g
背心	100 g
男士内衣	100 g

## 洗涤剂 and 添加剂

洗涤剂的选择和正确的使用量不仅带来好的洗涤效果，还可避免浪费，保护环境。虽然，洗涤剂所含的物质可以被降解，但如使用过量，会破坏生态平衡。

洗涤剂的选择取决于织物的类型（丝绸织物、羊毛、棉麻等），颜色，洗涤温度及脏污程度。

所有普通机用洗涤剂均可使用于本机：

- 适用于各类织物的洗衣粉。
- 适用于丝绸织物（最高温度60°C）和羊毛织物的洗衣粉。
- 液体洗涤剂，适用于各类织物的低温洗涤程序（最高温度60°C），或仅适于羊毛。

洗涤剂和添加剂必须在启动洗涤程序前加入相应的洗涤剂盛载格内。

如果使用浓缩洗涤剂或液体洗涤剂，必须选择无预洗的洗涤程序。

洗衣机带有再循环系统，可使浓缩洗涤剂得到充分利用。

在启动洗涤程序前，将液体洗涤剂倒入标志为  的洗涤剂盛载格内。

在启动洗涤程序前，必须将织物柔软剂或上浆剂倒入标有  的盛载格内。依照厂商推荐用量，不要超过洗涤剂抽屉盒内的“MAX”标志。

## 洗涤剂用量

洗涤剂的种类和用量取决于织物的种类、洗涤量、脏污程度和水质。

水质是按照硬度区分，有关各地区的水质资料可从有关自来水公司或当地权威机构获得。

洗涤剂用量请参考厂商的说明

下述情况，使用少量洗涤剂：

- 衣物洗涤量较少时
- 轻微脏污的衣物
- 泡沫多的洗涤剂

## 干衣指南

作为干衣机，本机以冷凝原理运作。因此，即使在烘干运行中也必须打开水龙头，并且排水管必须与下水道和排水管道相连。

### 干衣量确定

衣物种类	最大干衣量 (烘干重量)
棉麻织物	3.5 kg
化纤织物	2 kg

### 警告：

若所需烘干衣物重量超过上表值，则分量烘干，否则烘干效果不佳。





### 不适合烘干的衣物

- 尤其对精致类织物不宜用机器烘干，如化纤窗帘、羊毛和丝织制品、有金属嵌入物的衣物、尼龙袜、大件衣物如粗呢大衣、被面、围披、睡袋、羽绒被等等。
- 有泡沫-橡胶或类似材料作衬垫的衣物不能用机器烘干；它们有着火的危险。
- 而且，含有以下残余物的织物也不能用机器烘干，以避免有害气体的产生：洗发液或头发定型剂、指甲油去除剂或类似溶剂。

### 衣物标签上的干衣符号

请经常查看衣物标签以便确定衣物是否可用机器烘干。

以下为与烘干相关的符号：

-  通常可用机器烘干
-  常规烘干（常规温度）
-  轻柔烘干（较低温度）
-  不可用机器烘干

### 干衣时间

烘干时间可根据下述状况而改变：

- 最终脱水转速
- 所需的干衣程度（烘干、晾干、熨干）
- 织物类型
- 烘干量

通常的定时烘干时间在程序图中标明。你会找出不同织物种类的最适合的烘干时间。建议将这些时间作个记录。

### 残留纤维

在烘干带绒毛织物后，如新毛巾，建议通过“单选/重置”按钮运行漂洗程序，以确保可能滞留在筒内的纤维残留物被完全清除，不会粘在后面要烘干的衣物上。

每次烘干程序结束后，必须检查和清理排水过滤系统。

### 附加烘干

若烘干程序结束时，衣物仍然很潮湿，可另外设置短时烘干程序。

**警告！** 为防止织物起皱或缩水，须避免过度烘干。

## **i** 操作步骤

### 洗涤

在第一次洗涤前，我们建议在无衣物状态下运行棉麻程序（温度设定60℃）以便去除内、外筒内的制造遗留物。

在抽屉盒主洗涤剂投放格中加入一半量的洗涤剂，启动机器。

### 1. 把衣物放入洗衣机

打开机门

把衣物放入洗衣筒，每次放入一件，尽量把衣物抖开。

关上机门



### 2. 加入洗涤剂

把洗涤剂抽屉盒拉开，按照洗涤剂制造商的推荐用量，量取洗涤剂，倒入有 **U** 标记的抽屉盒主洗涤剂投放格内。

若想先运行预洗程序，请把洗涤剂倒入有 **U** 标记的预洗洗涤剂投放格内。

### 3. 加入添加剂

如需要，把织物柔软剂倒入有 **+** 标记的盛放格内，不要超出“MAX”标记

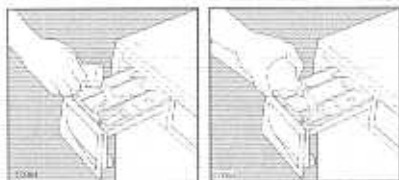

### 4. 接通电源

按下电源“开/关”按钮，接通电源，电源指示灯亮。

显示屏显示三条闪烁的横线或闪烁的数字“0”。

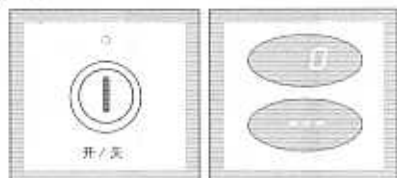

### 5. 选择所需的程序

重复按下“织物”选择按钮，选定所需的程序/织物，相应的指示灯亮。



该程序的各过程相应指示灯亮，显示屏将显示选定程序所运行的时间，以不同面料织物的最大洗涤容量为基准计算。启动/暂停指示灯将开始闪烁。

如果需要洗涤的衣物量较少，在洗衣的开始阶段，显示屏仍然显示相应织物最大洗涤量所运行的时间。此时时间值将在程序运行期间逐渐调整。

### 6. 选择洗衣温度

如果您想选择的温度不同于洗衣机设定的温度或您不想用冷水洗涤，按下“温度”按钮选择所需加热温度，相应的指示灯亮。



## 7. 选择脱水转速或免排水功能

重复按下“脱水转速”按钮，选择所需要的脱水转速或免排水功能。相应的指示灯亮。

如果选择了免排水功能，洗衣机在程序运行结束时，将不排水。



## 8. 选择需要的功能

预洗：如果要洗的衣物很重，建议选择预洗功能。

强漂洗：若您想增加一次漂洗，请选择强漂洗功能。

超快洗：如果要洗的衣物轻微脏污，请选择超快洗功能。



## 9. 选择预约时间

在启动程序之前，如果希望预约洗衣，重复地按动“预约”按钮或一直按着，可选择所需的预约时间。预约时间（最多24小时）将在显示窗上显示约3秒钟，然后显示程序运行时间。



## 10. 启动程序

按下“启动/暂停”按钮，相应指示灯停止闪烁，门锁指示灯亮，且仅有当前运行的过程的相应指示灯亮。

如果你选择了预约洗涤，洗衣机将开始倒计时。

显示窗将显示洗涤剩余时间或预约剩余时间。



## 11. 如何在程序运行期间改变程序

在做任何改变之前，请按下“启动/暂停”按钮，务必使洗衣机处于暂停状态。

在程序运行之前，可以改变任何过程。

显然，只有在洗衣期间才可改变织物类型和加热温度。当你改变了这两个参数，洗衣机将重新开始洗涤过程。

若为了改变正在运行的程序必须排水，请如下操作：

- 按下“启动/暂停”按钮，暂停洗衣机；
- 重复按下“单选/重置”按钮，直至排水指示灯亮；
- 再次按下“启动/暂停”按钮。

当水排完后，显示窗显示一个闪烁的数字“0”，这时您可以选择新的程序并且按下“启动/暂停”按钮启动机器。

## 12. 如何在程序运行期间取消程序

要取消正在运行的程序，首先按动“启动/暂停”按钮，暂停机器，然后重复按动“单选/重置”按钮，直到显示窗显示二条闪烁的横线。

### 13. 如何在程序运行期间打开门

下列情况下，暂停洗衣机后，可以将机门打开：

- 洗衣机不处于加热或烘干状态；
- 水位不高；
- 洗衣筒不转。

如果满足上述条件，当您暂停洗衣机时，门锁指示灯熄灭，机门就可以打开。

如果机门不能打开，但确实需要打开机门，请按下电源“开/关”按钮，切断洗衣机电源。大约三分钟后，机门就可以打开了。

**注意洗衣机中的水温和水位！**

当关上机门，并再次按下电源“开/关”按钮，洗衣机将从被中断处继续运行。

### 14. 程序运行结束

程序运行结束时，洗衣机自动停止，发出提示音并且显示闪烁的数字“0”。

如果您已选择了免排水功能，启动/暂停指示灯闪烁，提示必须排水。显示屏显示一个静态的数字“0”并且门锁指示灯亮。

当程序完全结束时，显示屏显示闪烁的数字“0”，并发出提示音。门锁指示灯立刻熄灭。重复按动“单选/重置”按钮，清除刚刚运行完的程序。如果忽略了此步，下次接通洗衣机电源时，显示屏将会出现闪烁的数字“0”，并且您会听到提示音。

**备注：**当接通洗衣机电源时，如果需清除先前运行的程序，您可以按下“织物”选择按钮，选择新的程序即可。

按下电源“开/关”按钮切断洗衣机电源，相应指示灯熄灭。

从洗衣机中取出衣物，用手转动洗衣筒，确认筒中没有衣物，避免偶尔遗忘在筒内的衣物在随后的洗涤中损坏（如皱缩）或将下次要洗的衣物染上颜色。

关掉水龙头并从插座上拔下电源插头。

微微打开洗衣机门，保持通风。

## 如何烘干3kg棉织物

假设您刚用洗衣机洗完6kg棉织物，并以1200 rpm的脱水转速进行了脱水。

烘干结束后，您还想对此中等重量的棉织物进行熨干，重复按动“单选/重置”按钮以清除刚运行完的程序。显示窗显示三条横线，请按电源“开/关”按钮关机。

从洗衣机内取出衣物并将它们分成两部份，每部份各重约3kg。

水龙头必须打开，排水管必须连接到水槽或排水管道。

1. 放入衣物。
2. 按下电源“开/关”接通洗衣机电源，显示窗显示三条横线。
3. 如果您想使用自动烘干，按动“自动烘干”按钮直至“熨干”指示灯点亮。



如果您想使用定时烘干，按“烘干时间”按钮直至棉麻指示灯好点点。然后按下同一按钮直至显示窗显示您所需要的烘干时间。



4. 按下“启动/暂停”按钮，启动机器。



5. 程序运行结束后，按“单选/重置”按钮清除先前的程序，然后按下电源“开/关”按钮关闭电源。
6. 取出衣物。

## 如何自动烘干2kg化纤织物

若您需要自动洗涤和烘干2kg无需熨烫的化纤织物。

洗涤和烘干程序运行时，请勿将量取器/球放入机内。

1. 放入衣物。
2. 加入洗涤剂 and 柔软剂(或上浆剂)。
3. 按下电源“开/关”按钮接通电源。
4. 选择洗涤程序/织物和加热温度。
5. 选择所需的功能，如果可能，不要选择低于机器设定的脱水转速，可以避免烘干时间过长，节省能源。无论如何，只有在选择烘干后才能降低脱水转速。可选择的最低转速如下：  
-900转/分钟：棉麻和化纤-自动烘干  
-900转/分钟：棉麻-定时烘干；700转/分钟：化纤-定时烘干
6. 选择烘干时间或烘干程度。
7. 按下“启动/暂停”按钮，启动机器。
8. 程序运行结束后，按“单选/重置”按钮清除先前的程序，然后按下电源“开/关”按钮关闭电源。
9. 取出衣物。

# 程序表

## 洗涤程序

织物类型	最大洗涤量	程序温度	程序描述	可选项	消耗*		
					耗电 千瓦时	耗水 升	耗时 小时/分钟
白色棉织物： 床单，桌布， 亚麻织物	6.5 kg	棉麻 60-95°C	60-95°C洗涤 三次漂洗 长脱水	脱水转速 免排水 预洗 强漂洗 超快洗	2.05	53	2.34
有色棉织物： 衬衫，夹克衫， 内衣，毛巾， 亚麻织物	6.5 kg	棉麻 60-40-30°C * 冷水	60-40-30°C 或 * 冷水洗涤 三次漂洗 长脱水	脱水转速 免排水 预洗 强漂洗 超快洗	1.19	49	2.23
化纤织物和 混纺织物： 衬衫，夹克衫， 内衣	3 kg	化纤 60-40-30°C * 冷水	60-40-30°C 或 * 冷水洗涤 三次漂洗 短脱水	脱水转速 免排水 预洗 强漂洗 超快洗	1.05	55	1.36
精致织物： 丙烯酸织物，纤 维胺，聚酯，化 纤，混纺	3 kg	丝绸 40-30°C * 冷水	40-30°C 或 * 冷水洗涤 三次漂洗 短脱水	脱水转速 免排水 预洗 强漂洗 超快洗	0.55	60	1.07
羊毛	2 kg	羊毛 40-30°C * 冷水	40-30°C 或 * 冷水洗涤 二次漂洗 短脱水	脱水转速 免排水	0.4	63	54
手洗织物	2 kg	手洗 40-30°C * 冷水	40-30°C 或 * 冷水洗涤 三次漂洗 短脱水	脱水转速 免排水	0.4	63	57

\* 表中所示的数据仅供参考；可能会根据衣物洗涤量，织物类型，水温和环境温度而改变。此数据在每个程序的最高温度下测得，洗涤量：棉织物6.5kg；化纤和丝绸织物3kg；羊毛和手洗织物2kg。

# 程序表

## 定时烘干

干衣程度	织物类别	最大干衣量	脱水转速	烘干时间 (分钟)
特干 对毛巾料较 为理想	棉织物和亚麻布 (浴衣、浴巾等)	3.5 kg	1200	95
		1.5 kg	1200	60
晾干 适合无需熨烫 而存放的衣物	棉织物和亚麻布 (毛巾、T恤、浴 衣)	3.5 kg	1200	85
		1.5 kg	1200	50
	化纤和混纺织物 (套衫、上衣、 内衣、亚麻布)	2kg	900	75
		1 kg	900	40
熨干 适合需熨烫 的衣物	棉麻织物 (被单、桌布、衬 衫等)	3.5 kg	1200	65
		1.5 kg	1200	45

## i 国际洗涤标志

织物上的标签符号，可帮助您选择最佳方法护理衣物。

 <p>强洗</p> <p>轻柔洗</p>	 <p>最高洗涤 温度95°C</p>	 <p>最高洗涤 温度60°C</p>	 <p>最高洗涤 温度40°C</p>	 <p>最高洗涤 温度30°C</p>	 <p>手洗</p>	 <p>不可洗</p>
--	--	--	--	--	---	--

 <p>漂白</p>	 <p>冷水漂白</p>	 <p>不可漂白</p>
---	---	---

 <p>可熨烫</p>	 <p>最高200°C熨烫</p>	 <p>最高150°C熨烫</p>	 <p>最高110°C熨烫</p>	 <p>不可熨烫</p>
--	--	--	--	---

 <p>干洗</p>	 <p>可用各种 溶剂干洗</p>	 <p>干洗： 用全氯乙烯， 汽油，纯酒精 R111和R113</p>	 <p>干洗： 用汽油，纯酒精 和R113</p>	 <p>不可干洗</p>
--	---	---	---	--

 <p>干衣</p>	 <p>平摊干衣</p>	 <p>放于挂绳上</p>	 <p>放于衣架上</p>	 <p>高温</p>  <p>低温</p> <p>可使用干衣机</p>	 <p>不可使用干衣机</p>
---	---	--	--	---	--

# 维护保养

## 1. 门封

经常检查门封，以防有物品掉落在门封折叠内。

## 2. 机身

用加洗洁剂的温水清洗机身，再用清水擦拭，最后用软布擦干。

注意：请勿用酒精、溶剂或类似产品清洁机身。

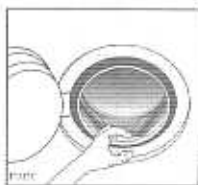

## 3. 洗涤剂抽屉盒

长时间使用后，洗涤剂和织物柔软剂会沉积在抽屉盒里。

请经常在水龙头下清洗抽屉盒。按住抽屉左后角处的按钮，取出抽屉盒。

为便于清洗，可将抽屉盒中柔软剂投放格上的附件取出。

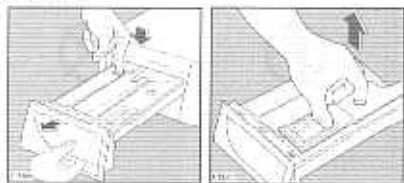

洗涤剂也可能堆积在洗涤剂盒的凹缝处，可用旧牙刷刷洗，清洗完毕后，将抽屉盒重新装回洗涤剂盒。

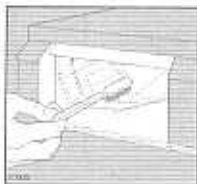

## 4. 排水过滤装置

应经常检查排水泵，尤其在下列情况下：

- 洗衣机不能排水和/或脱水。
- 由于别针、硬币等物品阻塞排水泵，洗衣机排水时发出异常响声，请按如下方法处理：
- 关断电源，拔下电源插头。
- 如有必要，等水冷却。
- 打开排水过滤器门。

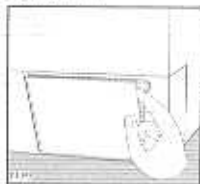

- 在靠近排水过滤器处放置容器，以收集溢出水。
- 取出紧急排水管，放在容器内，拔下管塞。
- 当不再有水排出时，拧松过滤器旋钮盖并取出。请在附近放置抹布以便擦干溢出的水。

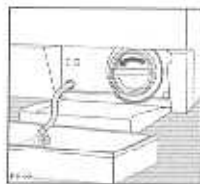

- 转动排水泵叶轮，取出异物。



- 把管塞重新装回紧急排水管，并将紧急排水管放回原位。

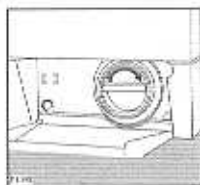

- 将过滤器旋钮盖旋上并确保拧紧。
- 关上过滤器门。

## 5. 进水阀过滤网

如果发现进水时间变长，请检查进水阀的过滤网没有堵塞。

关掉水龙头。

将进水软管从进水阀上拆下。

用硬刷清洗过滤网。

将软管重新装回进水网上。

## 6. 紧急排水

如果无法排水，请按下述方法将水排出。

- 将电源插头从插座上拔下；
- 关上水龙头；
- 如有必要，待水冷却；
- 打开过滤器门；

- 在地上放置一个盆，将紧急排水管末端放进盆中，拔下管塞，洗衣机内水会自然流回。当盆内水满后将管塞回紧急排水管，倒空盆中的水。重复以上过程，直至洗衣机内的水完全排出；

- 如有必要，请按前述方法清理排水泵；
- 将管塞回紧急排水管，并将该管放回原位；
- 将过滤器旋钮盖旋上并确保拧紧，关上过滤器门。

## 7. 预防冻结

如果洗衣机放置的地方温度会降低至  $0^{\circ}\text{C}$  以下，请按下述方法处理：

- 将电源插头从插座上拔下；
- 关闭水龙头，将进水管从水龙头上拆下来；
- 将紧急排水管及进水管的末端放入地板上的盆内，将水排出；
- 将进水管及塞上管塞后的紧急排水管重新装回原位；

经过上述步骤后，洗衣机内残留的水已排出，避免冻结成冰，损坏洗衣机部件。

当再次使用洗衣机时，请确认环境温度在  $0^{\circ}\text{C}$  以上。

# 故障诊断

可自己解决的问题

洗衣机运行中显示窗上有可能会显示下述报警代码：

-E10：与进水有关的故障

-E20：与排水有关的故障

-E40：洗衣机门未关上

故障消除后，按“启动/暂停”按钮重新启动程序；如果进行全面检查后，故障仍存在，请与当地的售后服务中心联系。

故障	可能的原因
洗衣机不启动	<ul style="list-style-type: none"><li>• 洗衣机机门未关严(E40)</li><li>• 洗衣机未插上电源或电源插座没电</li><li>• 主保险丝或插座保险丝烧断</li><li>• 未选择织物类型/程序</li><li>• “启动/暂停”按钮没有按下</li><li>• 选择了预约功能</li></ul>
洗衣机不进水	<ul style="list-style-type: none"><li>• 水龙头未打开(E10)</li><li>• 进水软管被挤压或扭结(E10)</li><li>• 进水阀过滤网堵塞(E10)</li><li>• 机门未完全关严(E40)</li></ul>
洗衣机边进水边排水	<ul style="list-style-type: none"><li>• 排水软管的末端太低。参阅相关的“排水”章节</li></ul>
洗衣机不排水和/或不脱水	<ul style="list-style-type: none"><li>• 排水软管被挤压或扭结(E20)</li><li>• 选择了免排水功能</li><li>• 排水泵堵塞(E20)</li></ul>
洗衣机周围地面上有水	<ul style="list-style-type: none"><li>• 使用了太多或高泡洗涤剂</li><li>• 检查进水管连接处是否漏水，这种情况不易看出，因为水会顺着进水管箱下，请检查进水管是否已潮湿</li><li>• 排水管被损</li><li>• 清洁后紧急排水管管塞未塞上</li></ul>
洗衣效果不满意	<ul style="list-style-type: none"><li>• 使用了过少的洗涤剂或不适宜洗涤剂</li><li>• 洗衣前没有预先处理顽固的污渍</li><li>• 没有选择正确的洗涤温度</li><li>• 超过洗涤容量</li></ul>
洗衣机振动及噪音大	<ul style="list-style-type: none"><li>• 未拆除运输螺栓和包装物</li><li>• 没有调节调整脚</li><li>• 洗衣筒内衣物分布不均匀</li><li>• 洗衣量太少</li></ul>
机门无法打开	<ul style="list-style-type: none"><li>• 程序仍在运行，洗衣筒在旋转</li><li>• 洗衣机正在加热，或正在烘干</li><li>• 水位高于机门玻璃底部边缘</li><li>• 门锁指示灯熄灭后才可打开机门</li></ul>

故障	可能的原因
脱水延时或脱水不充分	<ul style="list-style-type: none"> <li>• 由于洗衣筒内衣物分布不均匀，电子不平衡检测系统启动，通过洗衣筒的反向旋转，使衣物重新分布；在不平衡未消除前，此过程可能会发生几次，直到正常脱水可以进行。如果几分钟后衣物仍未分布均匀，洗衣机将进行低速脱水。如果程序结束时，衣物未充分脱水，请手动分布衣物并选择脱水程序。</li> </ul>
洗衣机不烘干或烘干不充分	<ul style="list-style-type: none"> <li>• 水龙头未打开(E10)</li> <li>• 排水过滤器阻塞(E20)</li> <li>• 未选择烘干时间或烘干程度</li> <li>• 未选择适当的烘干时间或烘干程度</li> <li>• 洗衣筒内的衣物太多</li> </ul>

洗衣机内看不见水  
本机是现代高科技的产物，耗水量低，运行经济，但性能卓越。

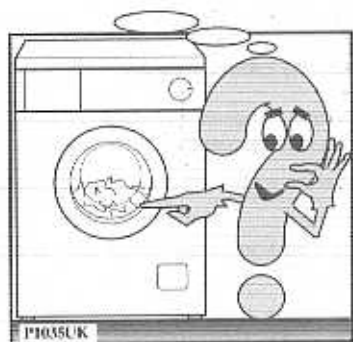

洗衣机发出异常响声  
这是由于本机装有提高机器性能的换向器电机。

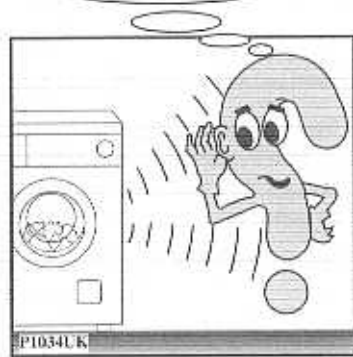

如果不能确定或解决问题，请联系我们的技术服务中心。打电话前，请记录机器的型号、序列号和购买日期，并将此信息告诉技术服务中心。

## Dear customer,

Please read these operating instructions carefully and pay particular attention to the safety notes indicated in the first pages. We recommend that you keep this instruction booklet for future reference and pass it on to any future owners.

## Transport damages,

When unpacking the appliance, check that it is not damaged. If in doubt, do not use it and contact the Service Centre.

*The symbols you will see on some paragraphs of this booklet have the following meaning:*



The warning triangle and/or the key words (Warning! , Caution! ) emphasize information that is particularly important for your safety or correct functioning of the appliance.



The information marked with this symbol provides additional instructions and practical tips on the use of the appliance.



Tips and information about economical and ecological use of the machine are marked with this symbol.

*Our contribution to the protection of the environment: we use environmentally friendly paper.*

# Contents

<b>Warnings</b>	<b>3-4</b>	<b>Washing hints</b>	<b>14</b>
<b>Disposal</b>	<b>4</b>	Sorting the laundry	14
<b>Tips for environmental protection</b>	<b>4</b>	Temperatures	14
<b>Technical specifications</b>	<b>5</b>	Removing stain before washing	14
<b>Installation</b>	<b>6</b>	Before loading the laundry	14
Unpacking	6	Maximum loads	14
Positioning	6	Laundry weights	14
Water inlet	6	Detergent and additives	15
Water drainage	7	Quantity of detergent to be used	15
Electrical connection	7	<b>Drying hints</b>	<b>16</b>
<b>Your new washer-dryer</b>	<b>8</b>	Load	16
<b>Description of the appliance</b>	<b>8</b>	Garments not suitable for drying	16
Door locked pilot light	8	Drying symbols on garment labels	16
Detergent dispenser drawer	8	Duration of the drying cycle	16
<b>Use</b>	<b>9</b>	Fibre residue	16
Control panel	9	Additional drying	16
ON/OFF button	9	Operating sequence	17-20
Mains-on light	9	Washing programmes	21
FABRICS button	9	Timed dryings	22
TEMPERATURE button	9	International wash code symbols	23
Spin speed button	9	<b>Maintenance</b>	<b>24</b>
OPTIONS button	10	Door seal	24
Electronic Drying button	10	Bodywork	24
Drying Time button	10	Detergent dispenser drawer	24
DISPLAY	10	Drain pump	24
START/PAUSE button	12	Water inlet filter	25
SKIP/RESET button	12	Emergency emptying out	25
DELAY START button	13	Frost precautions	25
Programme phase indicator lights	13	<b>Something not working?</b>	<b>26-27</b>

## Warnings

The following warnings are provided in the interests of overall safety. You must read them carefully before installing or using the appliance.

### Installation

- All internal packing must be removed before using the appliance. Serious damage may be caused to the machine or adjacent furniture if the protective transit devices are not removed or are not completely removed. Refer to the relevant paragraph in the instruction book.
- Any electrical work required to install this appliance must be carried out by a qualified plumber.
- Any plumbing work required to install this appliance must be carried out by a qualified plumber.
- After having installed the machine, check that it is not standing on its electrical supply cable.
- If the appliance is placed on a carpeted floor, ensure that air can circulate freely between the feet and the floor.
- If you use a liquid detergent with a dispenser which has to be placed directly in the drum, remember to remove this dispenser before drying.
- Use only the recommended quantities of fabric softener. An excessive amount could damage the laundry.
- Leave the porthole door slightly ajar when the appliance is not in use. This preserves the door seal and prevents the formation of musty smells.
- Always check that water has emptied out before opening the door. If not, drain the water following the instructions in the instruction book.
- Always unplug the appliance and shut the water tap after use.

### Use

- This appliance is designed for domestic use. It must not be used for purposes other than those for which it was designed.
- Only wash and dry fabrics which are designed to be machine washed and dried. Follow the instructions on each garment label.
- Do not overload the appliance. Follow the instructions in the instruction book.
- Make sure that all pockets are empty. Objects such as coins, safety pins, pins and screws can cause extensive damage.
- Do not machine wash garments saturated with petroleum, methylated spirits, trichloroethylene, etc. If such fluids have been used to remove stains prior to washing, wait until they have completely evaporated from the fabric before placing garments in the appliance.
- Place small items such as socks, belts, etc. in a cloth bag or pillowcase to prevent them getting trapped between the drum and the tub.

### General safety

- Repairs to the machine must be carried out only by qualified personnel. Repairs carried out by inexperienced persons could cause serious danger. Contact your local Service Centre.
- Never pull the power supply cable to remove the plug from the socket; always take hold of the plug itself.
- During high temperature wash programmes and during the drying cycle the door glass may get hot. Do not touch it!

## Child safety

- Children are often not aware of how dangerous electrical appliances can be. When the machine is working, children should be carefully supervised and not be allowed to play with the appliance.
- The packaging components (e.g. plastic film, polystyrene) can be dangerous to children—danger of suffocation! Keep them out of children's reach.
- Keep all detergents in a safe place out of children's reach.
- Make sure that children or pets do not climb into the drum. To avoid this the machine incorporates a special feature. To activate this device, rotate the button (without pressing it) inside the door clockwise until the groove is horizontal. If necessary use a coin.

- To disable this device and restore the possibility of closing the door, rotate the button anti-clockwise until the groove is vertical.

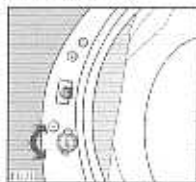

- When the appliance is to be scrapped, cut off the electrical supply cable and destroy the plug with the remaining cable. Disable the door catch in order to prevent children from becoming trapped inside while playing.



## Disposal

### Packaging materials

The materials marked with the symbol  are recyclable.

- > PE < = polyethylene
- > PS < = polystyrene
- > PP < = polypropylene

This means that they can be recycled by disposing of them properly in appropriate collection containers.

### Machine

Use authorised disposal sites for your old appliances. Help to keep your country tidy!



## Tips for environmental protection

To save water, energy and to help protect the environment, we recommend that you follow these tips:

- Normally soiled laundry may be washed without prewashing in order to save detergent, water and time (the environment is protected too!).
- The machine works more economically if it is fully loaded (for both washing and drying cycles).
- The machine will consume less energy if the laundry is **adequately spun** before being dried.
- With adequate pre-treatment, stains and limited soiling can be removed; the laundry can then be washed at a lower temperature.
- Measure out detergent according to the water hardness, the degree of soiling and the quantity of laundry being washed.

# Technical specifications

DIMENSIONS	Height	85 cm		
	Width	60 cm		
	Depth	61 cm		
MAXIMUM LOAD		<b>WASHING</b>	<b>DRYING</b>	
	Cotton	6.5 kg	3.5 kg	
	Synthetics	3 kg	2 kg	
	Delicates	3 kg		
	Woolens	2 kg		
SPIN SPEED		1200 rpm max.		
POWER SUPPLY VOLTAGE/FREQUENCY		220V/50 Hz		
TOTAL POWER ABSORBED		2000 W		
MINIMUM FUSE PROTECTION		10A		
WATER PRESSURE	Minimum	50 kPa		
	Maximum	800 kPa		

# Installation

## Unpacking

 All transit bolts and packing must be removed before using the appliance.

You are advised to keep all transit devices so that they can be refitted if the machine ever has to be transported again.

1. Using a spanner, unscrew and remove the two rear bottom screws. Slide out the two plastic pins.

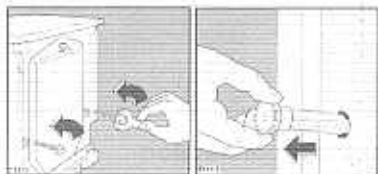

2. Lay the machine on its back, taking care not to squash the hoses. This can be avoided by placing one of the corner packing pieces between the machine and the floor.
3. Remove the polystyrene block(s) from the bottom of the machine. Unscrew and remove the four feet. Release the two plastic bags.
4. Very carefully slide out the left polythene bag, removing it towards the right and then downwards.



5. Very carefully slide out the right polythene bag, removing it towards the left and then upwards.

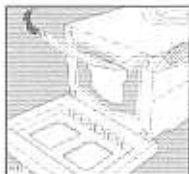

6. Set the machine upright and remove the remaining rear screw. Slide out the relevant pin.
7. Plug all the holes with the plugs which you will find in the envelope containing the instruction booklet.

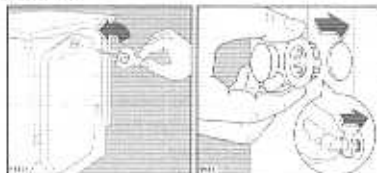

## Positioning

Install the machine on a flat hard floor.

Make sure that air circulation around the machine is not impeded by carpets, rugs etc. Check that the machine does not touch the wall or other kitchen units.

Carefully level by screwing the adjustable feet in or out. Never place cardboard, wood or similar materials under the machine to compensate for any unevenness in the floor.

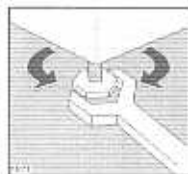

## Water inlet

- Take the inlet pipe connector out of the plastic bag(A and B)
- Put the juncture base A around the tap, fasten the four screws and fix the inlet connector B, which should ensure no water leakage.
- To insert inlet tube in the sliding connector, press the sliding knob C first, then put inlet tube in connector B, and pull the tube to confirm if it is surely in position.

- When connect the waving juncture with inlet valve, please avoid leakage and loose for joint deviation of screw thread.
- Pay attention to avoid the damage for over-bending.

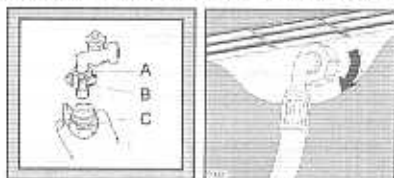

The inlet hose must not be lengthened. If it is too short and you do not wish to move the tap, you will have to purchase a new, longer hose specially designed for this type of use.

## Water drainage

The end of the drain hose can be positioned in three ways:

### Hooked over the edge of a sink using the plastic hose guide supplied with the machine.

In this case, make sure the end cannot come unhooked when the machine is emptying.

This could be done by tying it to the tap with a piece of string or attaching it to the wall.

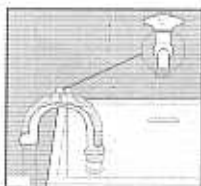

**In a sink drain pipe branch.** This branch must be above the trap so that the bend is at least 60 cm above the ground.

**Directly into a drain pipe at a height of not less than**

60 cm and not more than 90 cm.

The end of the drain hose must always be **ventilated**, i. e. the inside diameter of the drain pipe must be larger than the outside diameter of the drain hose.

The drain hose must not be kinked. Run it along the floor; only the part near the drainage point must be raised.

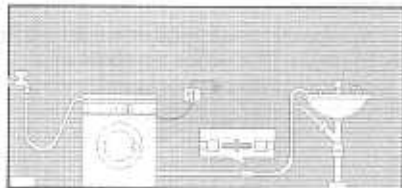

## Electrical connection

This machine is designed to operate on a 220 V, single-phase, 50 Hz supply.

Check that your domestic electrical installation can take the maximum load required (2,0 kW), also taking into account any other appliances in use.

**Connect the machine to an earthed socket.**



The manufacturer declines any responsibility for damage or injury through failure to comply with the above safety precaution.

Should the appliance power supply cable need to be replaced, this should be carried out by our Service Centre.

## Important!

The power supply cable must be easily accessible after installing the machine.

# Your new washer-dryer

This new machine, which is fitted with the New Jet System, patented Electrolux, meets all modern needs for effective treatment of laundry with low water, energy and detergent consumption. Further savings are achieved by washing small loads of laundry, since water and electricity consumption is proportional to the quantity and type of laundry being washed.



- The possibility of selecting the temperature, spin speed and all options offered by this machine gives you truly "customised" washing.
  - The **DELAY START** option allows you to delay starting of the wash programme to the desired time of day.
  - The **RINSE HOLD** function (stop with water in drum) can be selected for all fabrics: the laundry is left immersed in the final rinse water to avoid the formation of creases.
  - The **programme progress display** shows the programme steps selected and the programme phase which is running.
  - The **special wool programme** with its new delicate wash system treats your woollens with extreme care.
  - The **drying programmes** will give your wash that soft, relaxed feel whatever the weather.
- 3-compartment drawer for detergent and fabric softener.
- The balance control device ensures the machine is stable during the spin.

## Description of the appliance

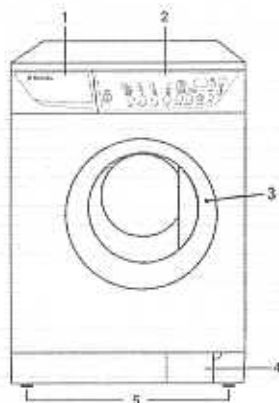
- 1 Detergent dispenser drawer
- 2 Control panel
- 3 Door locked pilot light
- 4 Drain pump
- 5 Adjustable feet



### Detergent dispenser drawer

-  Prewash
-  Main wash
-  Fabric softener, starch

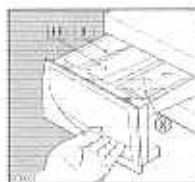

# Use

## Control panel

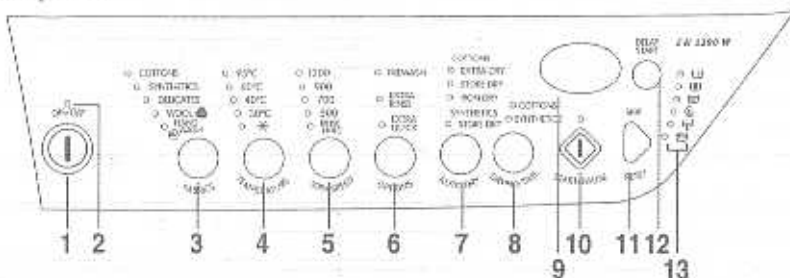

### 1 ON/OFF button

Press this button to switch the machine on. The display (9) will show three blinking dashes or a blinking zero. You will find more detailed explanations on page 10-11 (see DISPLAY). Press it again to switch the machine off.

### 2 Mains-on light

This light comes on when the ON/OFF button is pressed, and goes out when it is pressed again.

### 3 FABRICS button

Press this button repeatedly to select the programme on the basis of the type of laundry to be washed. The light relevant to the selected programme will light up. The machine will propose a temperature and automatically select the maximum spin value provided for the programme you have chosen. You can change these values by operating buttons 4 and 5.

#### Hand wash

When you select this programme, you obtain a particularly delicate washing, suitable for articles of clothing whose label indicates that they must be hand-washed .

### 4 TEMPERATURE button

Press this button repeatedly to increase or decrease the temperature, if you want your laundry to be washed at a temperature different from the one proposed by the machine. The relevant light will light up.

Maximum temperatures are 95°C for cotton, 60°C for synthetic fabrics, 40°C for delicate fabrics, wool and fabrics to be hand-washed (HAND WASH programme).

Position  corresponds to a COLD WASH. This option can be used for very delicate laundry, such as curtains.

### Important!

By depressing TEMPERATURE and SPIN SPEED buttons simultaneously, the acoustic signal at the end of the cycle, during the programme setting and in case of incorrect selection is suppressed.

### 5 Spin speed button

Press this button repeatedly to change the spin speed, if you want your laundry to be spun at a speed different from the one proposed by the machine. The relevant light will light up. Maximum speeds are:

- for cotton: 1,200 rpm;
- for synthetic fabrics, wool, and fabrics to be hand-washed: 900 rpm;
- for delicate fabrics: 700 rpm.

**RINSE HOLD position:** when you choose this option, the machine will not drain the water of the last rinse, so as not to wrinkle the laundry.

At the end of the cycle, the light of the START/PAUSE button will flash, the DOOR LOCKED light is on and a static zero will appear on the display to indicate that the water must be drained.

To complete the cycle, choose one of the following options:

#### • Draining and spin:

- Press the START/PAUSE button. The machine will drain the water, then spin the laundry at the maximum speed provided for the performed programme.

- Select **spin speed** by means of button 5, and press the START/PAUSE button.

- **Drain only**

- Press the SKIP/RESET button once, so as to cause the DRAIN light to light up, then press the START/PAUSE button.

**Important!**

If you accidentally press the SKIP/RESET button more than once, the display will show **three blinking dashes**. To cause the washing machine to drain the water, select any washing programme by means of the FABRICS button, then press SKIP/RESET **three times** in order to select the  $\frac{1}{2}$  position (only the  $\frac{1}{2}$  light will remain lit). Press the START/PAUSE button again.

## 6 OPTIONS button

Press this button to select the following option:

- **PREWASH:** select this option if you wish your laundry to be prewashed before the main wash (**not available for wool and hand-wash cycle**). The prewash ends with a short spin at 650 rpm in programmes for cotton and synthetic fabrics, whereas in the programme for delicate fabrics the water is only drained.

- **EXTRA RINSE:** this option can be used with all programmes except the wool and hand washed programme. The machine performs 4 rinses instead of 3.

this option is recommended for people who are allergic to detergents and in areas where the water is very soft.

- **EXTRA QUICK:** this button allows you to select the EXTRA QUICK function, for laundry that is only slightly soiled (not for wool and HAND WASH programme).

The washing time will be reduced according to the type of fabric and the selected temperature.

The PREWASH, EXTRA RINSE and EXTRA QUICK options cannot be selected together.

## 7 Electronic Drying button

By means of this button you can choose the required degree of drying for cottons and synthetics:

- Extra dry (cottons)
- Store dry (cottons and synthetics)
- Iron dry (cottons)

The corresponding pilot light illuminates.

The drying time is automatically adjusted by the machine: the laundry will be dried to the selected degree of dryness.

## 8 Drying Time button

By depressing this button you can select a timed programme for cotton or synthetics, the relevant light illuminates. To select "cottons" you have to push the button for about 2 seconds. To select the drying time push the button until the time you want appears in the display according to the fabrics (cotton or synthetics) you have to dry.

- For **COTTON** you can select a drying time from 10 minutes to 130 minutes (2.10).

For **SYNTHETICS** you can select a drying time from 100 minutes (1.40).

Every time you press the button the time increases, by 5 mins.

## 9 DISPLAY

The following pieces of information are shown on the display:

- **Three blinking dashes**, when a programme is cancelled by means of the SKIP/RESET button.

The three blinking dashes will also appear when you press the ON/OFF button to switch the machine on, if the previously selected cycle has been erased.

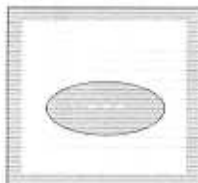

- **Duration of washing programme** in hours and minutes, after you have selected a programme. While the programme is running (after you have pressed the START/PAUSE button), the displayed time value decreases by one unit every minute.



- **The selected drying time** is displayed in minutes or hours and minutes.

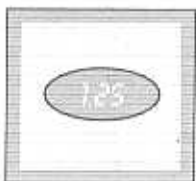

After starting the programme the remaining time is updated every minute.

- **The machine has stopped with water in the tub**, at the end of a programme with the RINSE HOLD option; this is indicated by a static zero.
- **The machine has completed the programme**: this is indicated by a blinking zero. At the same time, the door locked light goes out. The zero will reappear when you switch the washing machine on, unless the previous programme has been erased by means of the SKIP RESET button.



#### Important!

The first time you use the machine, when you switch it on, it may display a blinking zero and give an audible warning signal. This is due to the fact that the machine

has performed a washing cycle during the manufacturer's inspection tests, and this cycle has not been erased after its completion.

- **Delay start**, a time value indicated in hours and selected by means of the relevant button. The delay time is displayed for 3 seconds, then the duration of the selected programme reappears. After you have pressed the START/PAUSE button, the countdown begins, and the delay time value decreases by one unit every hour. You can delay the start of the selected programme by up to 24 hours in one hour intervals.



- **AN incorrect option selection has been made**: this is indicated by the message Err when a function incompatible with the current programme is selected. The incorrect selection is also indicated by an audible warning signal.



- **An alarm code indicates a fault in the machine operation** (see the relevant chapter on page 27).



## 10 START/PAUSE button

This button has three functions:

- **Start:** after you have selected the desired programme and options, press this button to start the machine. The light above the button will stop flashing and remain lit.

If you have selected a delay time by means of button 12, the countdown will begin and will be shown on the display.

- **Pause:** when you press this button again, the programme in progress is interrupted. The light above the button will start flashing. To restart the programme, press the button again.



When you PAUSE the cycle, the DOOR LOCKED light goes out, and it becomes possible to open the door, provided

- the machine is not in the heating or drying phase;
- the level of the water is not high;
- the drum is not turning.

### Important!

You must set the machine to PAUSE before you make any change in the programme in progress.

- **Draining of water and spinning** after the execution of programmes with the RINSE HOLD option.

## 11 SKIP/PESET button

At the end of a programme, you must press this button once or repeatedly, in order to clear the contents of the memory (the display will show three blinking dashes); otherwise, the next time you switch the machine on, the blinking zero will reappear and the audible warning signals relevant to the end of the previous cycle will be given.



You can also press the SKIP/RESET button to exclude one or several phases of the programme which is running, as indicated below.

- set the machine to PAUSE by pressing the START/PAUSE button (the relevant light will flash);
- press the SKIP/RESET button once or several times, until the required phase(s) is(are) cancelled (the light next to the name of the phase(s) will go out).

### Example:













In this case, both the drain and the spin (at the speed provided for the selected type of fabric) will be performed.

This button allows you also to select special programmes, such as  (rinses),  (spin) and  (drain).

- **If the machine is already switched on** because it has just performed a washing programme, proceed as follows:

- depress SKIP/RESET once or repeatedly to cancel the previously performed programme;
- select the type of fabric by means of FABRICS button;
- select the special programme;

-  (RINSES)  
Depress SKIP/RESET **once**, the pilot light  (WASH) goes out.
-  (SPIN)  
Depress SKIP/RESET **twice**, the pilot lights  (WASH) and  (RINSES) go out.
-  (DRAIN)  
Depress SKIP/RESET **three times**, the pilot lights  (WASH),  (RINSES) and  (SPIN) go out, and the pilot light  will light on.

### Example:



In this case the machine will perform the rinses followed by the spin.

- If the machine is switched off:
  - depress ON/OFF button to switch it on;
  - select the type of fabric by means of FABRICS button;
  - select the special programme as previously described.

## 12 DELAY START button

This button makes it possible to delay the starting of the programme by up to 24 hours. The delay you have selected is shown on the display for about 3 seconds; afterwards, the duration of the programme reappears.

You must select this option **after** you have set the programme and **before** you press the START/PAUSE button.

The time value shown on the display will decrease by one unit every hour.

You can change the delay time at any moment, before you press the START/PAUSE button.

If you have already pressed the START/PAUSE button, and you wish to **change** or **cancel** the delay time, proceed as follows:

- set the washing machine to PAUSE by pressing the START/PAUSE button;
- press the DELAY button until the display shows the desired delay time or
- press the DELAY button once, to erase the delay time. The display will indicate "0h"
- press the START/PAUSE button again.

### Important!

The door will be locked throughout the delay time (DOOR LOCKED light lit).

If you need to open the door, you must first set the machine to PAUSE by pressing the START/PAUSE button. After you have closed the door, press the START/PAUSE button again.

## 13 Programme phase indicator lights

When you select a programme, the lights relevant to the phases that form the programme light up.



After you have started the programme, only the light relevant to the phase that is currently being carried out will remain lit.

## **i** Washing hints

### Sorting the laundry

Follow the wash code symbols on each garment label and the manufacturer's washing instructions. Sort the laundry as follows:

whites, coloureds, synthetics, delicates, woollens.

### Temperatures

**95°** for normally soiled white cottons and linen (e. g. tea cloths, towels, tablecloths, sheets...)

**60°** for normally soiled, colour fast garments (e. g. shirts, night dresses, pyjamas....) in linen, cotton or synthetic fibres and for lightly soiled white cotton (e. g. underwear).

✕ (cold) for delicate items (e. g. net curtains), mixed **30°-40°** laundry including synthetic fibres and woollens.

### Removing stain before washing

Stubborn stains may not be removed by just common detergent. It is therefore advisable to treat them prior to washing.

If you use volatilizable organic solvent (e. g. alcohol, petroleum) to treat the stains, please put the laundry into the drum after this solvent has vaporized completely.

### Before loading the laundry

Never wash whites and coloureds together. Whites may lose their "whiteness" in the wash.

New coloured items may run in the first wash; they should therefore be washed separately the first time.

**Make sure that no metal objects are left in the laundry (e. g. hair clips, safety pins, pins)**

Button up pillowcases, close zip fasteners, hooks and poppers. Tie any belts or long tapes.

Remove persistent stains before washing. Rub particularly soiled areas with a special detergent or detergent paste.

Treat curtains with special care. Remove hooks or tie them up in a bag or net.

### Maximum loads

Recommended loads are indicated in the programme charts.

General rules:

**Cotton, linen:** drum full but not too tightly packed;

**Synthetics:** drum no more than half full;

**Delicate fabrics and woollens:** drum no more than one third full.

Washing a maximum load makes the most efficient use of water and energy.

For heavily soiled laundry, reduce the load size.

### Laundry weights

The following weights are indicative:

bathrobe	1200g
napkin	100g
quilt cover	700g
sheet	500g
pillow case	200g
tablecloth	250g
towelling towel	200g
tea cloth	100g
night dress	200g
ladies'briefs	100g
man's work shirt	600g
man's shirt	200g
man's pyjamas	500g
blouse	100g
men's underpants	100g

## Detergents and additives

Good washing results also depend on the choice of detergent and use of the correct quantities to avoid waste and protect the environment. Although biodegradable, detergents contain substances which, in large quantities, can upset the delicate balance of nature.

The choice of detergent will depend on the type of fabric (delicates, woollens, cottons, etc.), the colour, washing temperature and degree of soiling.

All commonly available washing machine detergents may be used in this appliance:

- powder detergents for all types of fabric,
- powder detergents for delicate fabrics (60 °C max) and woollens,
- liquid detergents, preferably for low temperature wash programmes (60 °C max) for all types of fabric, or special for woollens only.

The detergent and any additives must be placed in the appropriate compartments of the dispenser drawer before starting the wash programme.

If using concentrated powder or liquid detergents, a programme **without** prewash must be selected.

The washing machine incorporates a recirculation system which allows an optimal use of the concentrated detergent.

Pour liquid detergent into the dispenser drawer compartment marked  just before starting the programme.

Any fabric softener or starching additives must be poured into the compartment marked  before starting the wash programme.

Follow the product manufacturer's recommendations on quantities to use and **do not exceed the {MAX} mark in the detergent dispenser drawer.**

## Quantity of detergent to be used

The type and quantity of detergent will depend on the type of fabric, load size, degree of soiling and hardness of the water used.

Water hardness is classified in so-called "degrees" of hardness. Information on hardness of the water in your area can be obtained from the relevant water supply company, or from your local authority. Follow the product manufacturers' instructions on quantities to use.

Use less detergent if:

- you are washing a small load,
- the laundry is lightly soiled,
- large amounts of foam form during washing.

## **i** Drying hints

As a dryer, the machine works on the condensation principle.

Therefore, the water tap must be open and the

drain hose must drain water into a sink or into the drain pipe, even during the drying cycle.

### Load

Sort of laundry	max. load (dry weight)
Linen and cottons	3.5 kg
Synthetics	2 kg

### Warning:

Loads of washed laundry exceeding these values must be divided before being dried, otherwise poor results will be obtained.

### Garments not suitable for drying

- Particularly delicate items such as synthetic curtains, woollen and silk, garments with metal inserts, nylon stockings, bulky garments such as anoraks, bedcovers, quilts, sleeping bags and duvets must not be machine dried.
- Garments padded with foam-rubber or materials similar to foam-rubber must not be machine dried; they represent a fire hazard.
- Also, fabrics containing residues of setting lotions or hair sprays, nail solvents or similar solutions must not be machine dried in order to avoid the formation of harmful vapours.

## Drying symbols on garment labels

Always look at the garment label to check whether garments can be machine dried.

The following symbols refer to drying:

- Machine drying is usually possible
- Normal drying (normal temperature)
- Gentle drying (reduced temperature)
- Do not machine dry

## Duration of the drying cycle

The drying time can vary according to

- the final spin speed;
- the required degree of drying (extra dry, store dry or iron dry);
- the type of laundry;
- the size of load.

The usual drying times for the timed programmes are indicated in the programme chart. As you become more familiar with the appliance, you will discover the drying times that best suit your needs according to the various type of fabric. It is a good idea to make a note of these times.

## Fibre residue

After drying fluffy fabrics, such as new towels, it is advisable to perform the rinse programme by means of the SKIP/RESET button to be sure that any residue that may remain in the tub is completely removed and does not stick to garments dried afterwards.

**After each drying cycle the filter should be checked and cleaned.**

## Additional drying

Should the laundry still be too wet at the end of the programme, set another short drying cycle.

**Warning!** To prevent the formation of creases or shrinking of fabrics, avoid excessive drying.

## **i** Operating sequence

### Washing only

Before washing your first load of laundry, we recommend that you run a cotton cycle at 60°C, with the machine empty, in order to remove any manufacturing residue from the drum and tub. Pour half a measure of detergent into the main wash compartment and start up the machine.

#### 1. Place the laundry in the drum

Open the door.

Place the laundry in the drum, one item at a time, shaking them out as much as possible.

Close the door.



#### 2. Measure out the detergent

Pull out the dispenser drawer until it stops. Measure out the amount of detergent recommended by the manufacturer in a graduated cup and pour it into the main wash compartment (U).

If you wish to carry out the prewash programme, pour detergent into the appropriate compartment marked

U

#### 3. Measure out the additive

If required, pour fabric softener into the compartment marked , without exceeding the **MAX** mark.

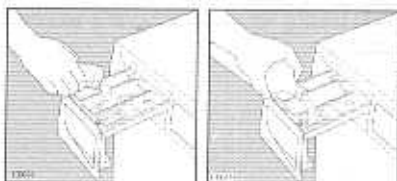

#### 4. Switch the machine on

press the ON/OFF button to switch the machine on. The display will show three blinking dashes or a blinking zero. The light above the button will light up.

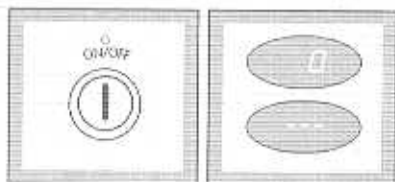

#### 5. Select the desired programme

Press the FABRICS button repeatedly, in order to select the desired programme/ fabric.

The relevant light will light up.

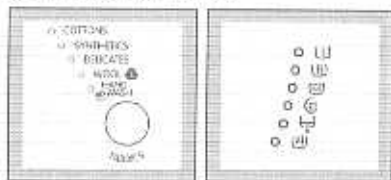

The lights relevant to the phases that form the programme will light up.

The display will show the duration of the selected programme, calculated on the basis of the maximum load for each type of fabric. The light of START/PAUSE button will start flashing.

If the load of laundry to be washed is small, at the beginning of the cycle the display will still indicate the duration relevant to the maximum load. The duration value will be gradually adjusted during the execution of the cycle.

#### 6. Select the temperature

Press the TEMPERATURE button if you wish to select a temperature value different from the one proposed by the machine or the  (COLD WASH). The relevant light will light up.



## 7. Select the spin speed or RINSE HOLD options

Press the SPIN SPEED button repeatedly, in order to select the desired spin speed or the RINSE HOLD option. The relevant light will light up.

If you select the RINSE HOLD option, the machine will stop at the end of the programme with the water still in the tub.

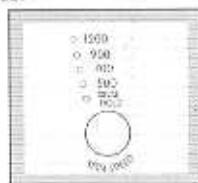

## 8. Select the desired options

If your laundry is very dirty, it may be advisable to select the PREWASH option.

If your laundry is only slightly soiled, select the EXTRA QUICK option.

The relevant light illuminates.



## 9. Select the DELAY TIME

Before you start the programme, if you wish the starting to be delayed, press the DELAY button repeatedly, or keep it pressed, to select the desired delay.

The selected delay time value (up to 24 hours) will appear on the display for 3 seconds, then the duration of the programme will appear again.

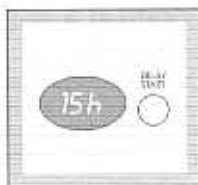

## 10. Start the programme

Press the START/PAUSE button. The relevant light will stop flashing. the DOOR LOCKED light will light up, and only the light relevant to the phase that is in progress will remain lit.

If you have chosen a delayed start, the washing machine will begin the countdown.

The display will show the duration of the programme or the selected delay.



## 11. How to change a programme during its cycle

Before you make any change, you must pause the machine by pressing the START/PAUSE button.

It is possible to change any phase before the programme carries it out.

Changing the type of fabric or temperature is possible, obviously, only during the washing phase.

When you make a change in these two parameters, the machine will resume the cycle from the beginning. If it is necessary to drain the water in order to change the programme in progress, proceed as follows:

- PAUSE the machine by pressing the START/PAUSE button;
- press the SKIP/RESET button repeatedly, until only the  light remains lit;
- press the START/PAUSE button again.

When the water has been drained, the display shows a blinking zero.

You may now select a new programme and press the START/PAUSE button to start it.

## 12. How to cancel a programme during its cycle

To cancel a programme that is being carried out, first pause the machine by pressing the START/PAUSE button, then press the START/PAUSE button repeatedly, until the display shows three blinking dashes.

## 13. How to open a programme during its cycle

You can open the door, after having set the washing machine to PAUSE, provided the following conditions exist:

- the machine is not in the heating phase;
- the level of the water is not high;
- the drum is not turning.

If these requirements are met, when you pause the machine, the DOOR LOCKED light goes out and the door can be opened.

Should it not be possible to open the door, and should it be absolutely necessary to do so, switch the machine off by pressing the ON/OFF button.

After approximately 3 minutes, you can open the door. **Pay attention to the level and temperature of the water in the machine!**

When you close the door and press the ON/OFF button again, the machine will resume the programme from the point where it had been interrupted.

## 14. At the end of the programme

At the end of the programme, the machine stops automatically, gives an audible signal, and displays a blinking zero.

If you had selected the RINSE HOLD option, the START/PAUSE button light flashes to indicate that the water must be drained. The display shows a steadily lit zero and the DOOR LOCKED light is on. When the programme has been completed, a blinking zero appears on the display and the audible signal is given.

The DOOR LOCKED light goes out at once.

Press the SKIP/RESET button repeatedly to erase the programme that has just been carried out. If you omit to do this, the next time you switch the machine on, the blinking zero will appear on the display and you will hear the audible signal.

**Note:** when you switch the machine on, if you must erase the previously performed programme, it is also sufficient to press the FABRICS button and select a new programme.

Press the ON/OFF button to switch the machine off. The relevant light will go out.

Remove the laundry from the machine.

Check whether the drum is completely empty, by rotating it with your hand. The purpose of this is to prevent any items of laundry from remaining accidentally in the drum, where they might get damaged in a subsequent wash (e.g. by shrinking) or bleed colour into another load of laundry.

We advise you to close the water supply tap and disconnect the plug from the socket.

Leave the door ajar in order to air the machine.

## Drying 3 kg of cotton

You have for example just machine-washed and spun at 1200 rpm 6 kg of laundry.

They are cotton fabrics of medium weight which you want to iron as soon as they are dry.

Press the SKIP/RESET button repeatedly to erase the programme that has just been carried out, the display will show 3 dashes and switch the machine off by depressing ON/OFF button.

Then remove the laundry from the appliance and divide the items to obtain two loads of approx. 3 kg each.

**The water tap must be open and the drain hose must be positioned in the sink or connected to the drain pipe.**

1. Load the laundry
2. Depress the ON/OFF button to switch the machine on, the display will show 3 dashes.
3. If you wish to carry out the electronic drying, depress AUTO DRY button until the light IRON DRY illuminates.

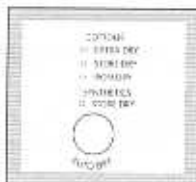

If you want a timed drying, depress the DRYING TIME button until the light COTTONS lights up, then depress the same button until the time you want appears on the display.



4. Press the START/PAUSE button to start the programme.



5. At the end of the programme press SKIP/RESET button to clear the memory and switch the machine off by depressing ON/OFF button.

6. Remove the laundry.

## Autodrying 2 kg of synthetics

You intend to wash and dry automatically 2 kg of synthetics which do not need ironing.

**Do not use a dosing device/ball when carrying out a washing & drying programme.**

1. Load the laundry

2. Add detergent and additive.

3. Switch the machine on by depressing the ON/OFF button.

4. Select the wash programme/fabric and temperature.

5. Select eventually the required options by means of the relevant buttons. If possible, do not select a spin speed lower than that proposed by the appliance to avoid a too long drying time so saving energy.

In any case the reduction of the spin speed is only possible after selecting drying. The lowest values you can select are the following:

- 900 r. p. m. for cottons & synthetics with electronic drying

- 900 r. p. m. for cottons and 700 r. p. m. for synthetics with timed drying

6. Select the drying time or degree of drying.

7. Start the programme by depressing the START/PAUSE button.

8. At the end of the programme, press SKIP/RESET button to clear the memory and press the ON/OFF button again to switch the machine off.

9. Remove the laundry.

# Programme table

## Washing programmes

Type of laundry and symbols on labels	Max. load	Programme/temperature	Description of programme	Available options	Consumption*		
					Energy kWh	Water litres	Time h/min.
 <b>White cotton:</b> e.g. sheets, tablecloths, household linen	6.5 kg	Cottons 60° - 95 °C	Wash at 60° - 95 °C 3 rinses Long spin	SPIN SPEED RINSE HOLD PREWASH EXTRA RINSE EXTRA QUICK	2.05	53	2.34
 <b>Coloured cotton:</b> e.g. shirts, blouses, underwear, towels, house- hold linen	6.5 kg	Cottons 60° - 40° - 30 °C ✕ (cold)	Wash at 60° - 40° - 30 °C or ✕ 3 rinses Long spin	SPIN SPEED RINSE HOLD PREWASH EXTRA RINSE EXTRA QUICK	1.19	49	2.23
 <b>Synthetic fabrics and blends:</b> e.g. shirts, blouses, underwear	3 kg	Synthetics 60° - 40° - 30 °C ✕ (cold)	Wash at 60° - 40° - 30 °C or ✕ 3 rinses Short spin	SPIN SPEED RINSE HOLD PREWASH EXTRA RINSE EXTRA QUICK	1.05	55	1.36
 <b>Delicate fabrics:</b> e.g. acrylic fabrics, viscose, polyester, synthetic blends	3 kg	Delicates 40° - 30 °C ✕ (cold)	Wash at 40° - 30 °C or ✕ 3 rinses Short spin	SPIN SPEED RINSE HOLD PREWASH EXTRA RINSE EXTRA QUICK	0.55	60	1.07
 <b>Wool</b> 	2 kg	<b>Wool</b>  40° - 30 °C ✕ (cold)	Wash at 40° - 30 °C or ✕ 3 rinses Short spin	SPIN SPEED RINSE HOLD	0.4	63	54
Items to be hand washed 	2 kg	Hand wash  40° - 30 °C ✕ (cold)	Wash at 40° - 30 °C or ✕ 3 rinses Short spin	SPIN SPEED RINSE HOLD	0.4	63	57

\* This data is given purely as an indication: the consumption values may vary in relation to the quantity and type of laundry, the temperature of the water supply and the ambient temperature. The data refers to the highest temperature provided for each programme and to a wash load of 6.5kg of cotton items, 3 kg of synthetics and delicates and 2 kg for wool and hand wash.









# Programme table



## Timed drying



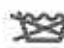
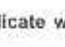

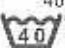
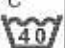
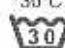
Degree of drying	Type of fabric	Max.load	Spin speed	Drying time mins
Extra dry Ideal for towelling materials	Cotton and linen (bathrobes, bath towels, etc.)	3.5 kg	1200	95
		1.5 kg	1200	60
Store dry Suitable for items to put away without ironing	Cotton and linen (towels, T- shirts, bathrobes)	3.5 kg	1200	85
		1.5 kg	1200	50
	Synthetics and mixed fabrics (jumpers, blouses, underwear, household linen)	2 kg	900	75
		1 kg	900	40
Iron dry Suitable for ironing	Cotton and linen (sheets, tablecloths, shirts,etc.)	3.5 kg	1200	65
		1.5 kg	1200	45





## **i** International wash code symbols







These symbols appear on fabric labels, in order to help you choose the best way to treat your laundry.

<b>Energetic wash</b>  	 Max. wash temperature 95 °C	 Max. wash temperature 60 °C	 Max. wash temperature 40 °C	 Max. wash temperature 30 °C	 Hand wash	 Do not wash at all
	<b>Delicate wash</b> 		 			

 <b>Bleaching</b>	 Bleach in cold water	 Do not bleach
---	---	--

 <b>Ironing</b>	 Hot iron max 200 °C	 Warm iron max 150 °C	 Lukewarm iron max 110 °C	 Do not iron
---	--	---	---	--

 <b>Dry cleaning</b>	 Dry cleaning in all solvents	 Dry cleaning in perchlorethylene, petrol, pure alcohol, R111 & R 113	 Dry cleaning in petrol, pure alcohol and R 113	 Do not dry clean
---	--	--	--	--

 <b>Drying</b>	 Flat	 On the line	 On clothes hanger	 high temperature  low temperature Tumble dry	 Do not tumble dry
--	---	--	--	---	--

# Maintenance

## 1. Door seal

Check from time to time the door seal and eliminate eventual possible objects that could be trapped in the fold.

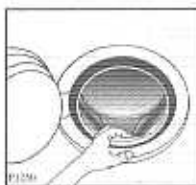

## 2. Bodywork

Clean the outside of the machine with warm water and a detergent used to handwash dishes. Rinse with clean water and dry with a soft cloth.

Important: do not use methylated spirits, solvents or similar products to clean the bodywork.

## 3. Detergent dispenser drawer

After a while, detergents and fabric softeners leave deposits in the drawer.

Clean the drawer from time to time by rinsing it under a running tap. To remove the drawer from the machine, press the button in the rear left-hand corner.

To facilitate cleaning, the top part of the additive compartments can be removed.

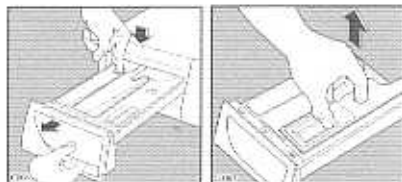

Detergent can also accumulate inside the drawer recess: clean it with an old toothbrush. Refit the drawer after cleaning.

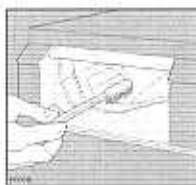

## 4. Drain pump

The pump should be inspected if

- the machine does not empty and/or spin
- the machine makes an unusual noise during draining due to objects such as safety pins, coins etc. blocking the pump.

Proceed as follows:

- Disconnect the appliance.
- If necessary wait until the water has cooled down.
- Open the pump door.

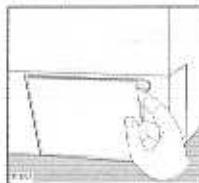

- Place a container close to the pump to collect any spillage.
- Release the emergency emptying hose, place it in the container and remove its cap.
- When no more water comes out, unscrew the pump and remove it. Always keep a rag nearby to dry up spillage of water when removing the pump.

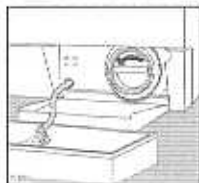

- Remove any objects from the pump impeller by rotating it.

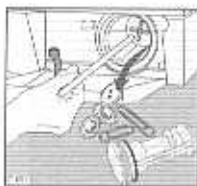

- Put the cap back on the emergency emptying hose and place the latter back in its seat.

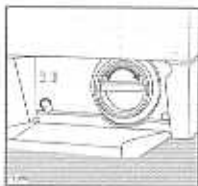

- Screw the pump fully in.
- Close the pump door.

## 5. Water inlet filter

If you notice that the machine is taking longer to fill, check that the filter in the water inlet hose is not blocked.

Turn off the water tap.

Unscrew the hose from the inlet valve.

Clean the filter with a stiff brush.

Screw the hose back onto the inlet valve.

## 6. Emergency emptying out

If the water is not discharged, proceed as follows to empty out the machine:

- pull out the plug from the power socket;
- close the water tap;
- if necessary, wait until the water has cooled down;
- open the pump door.

- place a bowl on the floor and place the end of the emergency emptying hose into the bowl. Remove its cap. The water should drain by gravity into the bowl. When the bowl is full, put the cap back on the hose. Empty the bowl. Repeat the procedure until water stops flowing out;
- clean the pump if necessary as previously described;
- replace the emergency emptying hose in its seat after having plugged it;
- screw the pump again and close the door.

## 7. Frost precautions

If the machine is installed in a place where the temperature could drop below 0 °C, proceed as follows:

- Remove the plug from the socket.
- Close the water tap and unscrew the water inlet hose from the tap.
- Place the end of the emergency emptying hose and that of the inlet hose in a bowl placed on the floor and let water drain out.
- Screw the water inlet hose back on and reposition the emergency emptying hose after having put the cap on again.

By doing this, any water remaining in the machine is removed, avoiding the formation of ice and, consequently, breakage of the affected parts.

When you use the machine again, make sure that the ambient temperature is above 0 °C.

# Something not working?

*Problems which you can resolve yourself.*

During machine operation it is possible that one of the following alarm codes appears on the display:

- E10: problem with the water supply
- E20: problem with water draining
- E40: door open

Once the problem has been eliminated, press the START/PAUSE button  to restart the programme. If after all checks, the problem persists, contact your local Service Centre.

Problem	Possible cause
<b>The machine does not start up:</b>	<ul style="list-style-type: none"> <li>• The door is not firmly closed. (E40)</li> <li>• The machine is not plugged in or there is no power at the socket.</li> <li>• The main fuse or the fuse in the plug has blown.</li> <li>• The type of fabric has not been selected by means of the relevant button.</li> <li>• The START/PAUSE button has not been depressed.</li> <li>• The DELAY START option has been selected.</li> </ul>
<b>The machine does not fill:</b>	<ul style="list-style-type: none"> <li>• The water tap is closed. (E10)</li> <li>• The inlet hose is squashed or kinked. (E10)</li> <li>• The filter in the inlet hose is blocked. (E10)</li> <li>• The door is not properly closed. (E40)</li> </ul>
<b>The machine fills then empties immediately:</b>	<ul style="list-style-type: none"> <li>• The end of the drain hose is too low. Refer to relevant paragraph in "water drainage" section.</li> </ul>
<b>The machine does not empty and/or does not spin:</b>	<ul style="list-style-type: none"> <li>• The drain hose is squashed or kinked. (E20)</li> <li>• The RINSE HOLD option <input type="checkbox"/> has been selected.</li> <li>• The drain pump is clogged. (E20)</li> </ul>
<b>There is water on the floor:</b>	<ul style="list-style-type: none"> <li>• Too much detergent or unsuitable detergent (creates too much foam) has been used.</li> <li>• Check whether there are any leaks from one of the inlet hose fittings. It is not always easy to see this as the water runs down the hose; check to see if it is damp.</li> <li>• The drain hose is damaged. The cap on the emergency emptying hose has not been replaced after cleaning the pump.</li> </ul>
<b>Unsatisfactory washing results:</b>	<ul style="list-style-type: none"> <li>• Too little detergent or unsuitable detergent has been used.</li> <li>• Stubborn stains have not been treated prior to washing.</li> <li>• The correct temperature was not selected.</li> <li>• Excessive laundry load.</li> </ul>
<b>The machine vibrates or is noisy:</b>	<ul style="list-style-type: none"> <li>• The transit bolts and packing have not been removed.</li> <li>• The support feet have not been adjusted.</li> <li>• The laundry is not evenly distributed in the drum.</li> <li>• Maybe there is very little laundry in the drum.</li> </ul>
<b>The door will not open:</b>	<ul style="list-style-type: none"> <li>• The water level is above the bottom edge of the door.</li> <li>• The machine is heating the water or drying clothes.</li> <li>• The drum is turning. The door can only be opened when the relevant light has gone out.</li> </ul>

Problem	Possible cause
<p><b>Spinning starts late or the laundry is not spun enough:</b></p>	<ul style="list-style-type: none"> <li>• The electronic unbalance detection device has cut in because the laundry is not evenly distributed in the drum. The laundry is redistributed by reverse rotation of the drum. This may happen several times before the unbalance disappears and normal spinning can resume. If, after few minutes, the laundry is still not evenly distributed in the drum, the machine will spin at a lower speed. If at the end of the programme the laundry is not spun enough, redistribute the load manually and select the spin programme.</li> </ul>
<p><b>The machine will not dry or the laundry is not dry enough</b></p>	<ul style="list-style-type: none"> <li>• The water tap is closed (E10).</li> <li>• The drain filter is clogged (E20).</li> <li>• The drying time or degree of dryness has not been selected.</li> <li>• An appropriate drying time or degree of dryness has not been chosen.</li> <li>• There is too much laundry inside the appliance.</li> </ul>

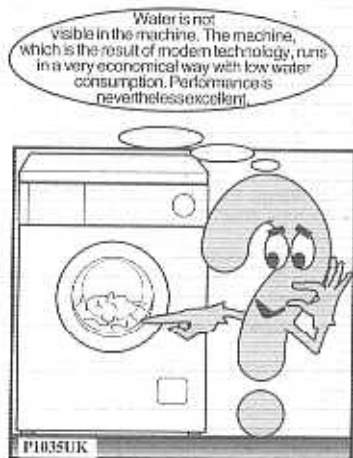

If you are unable to identify or solve the problem, contact our service centre. Before telephoning, make a note of the model, serial number and purchase date of your machine; the Service Centre will require this information.



163100210  
Rev.0  
03/07/01

全国统一免费服务热线: 95105801

 **Electrolux**

伊莱克斯(中国)电器有限公司

地址: 湖南省长沙市中意二路

邮编: 410118

制造地: 意大利

电子邮件: [eluxs.cn@public.bal.net.cn](mailto:eluxs.cn@public.bal.net.cn)

主页: <http://www.electrolux.com.cn>

 The Electrolux Group. The world's No. 1 choice.

The Electrolux Group is the world's largest producer of powered appliances for kitchen, cleaning and outdoor use. More than 55 million Electrolux Group products (such as refrigerators, ovens, washing machines, vacuum cleaners, chain saws and lawn mowers) are sold each year to a value of approx. USD 14 billion in more than 150 countries around the world.